

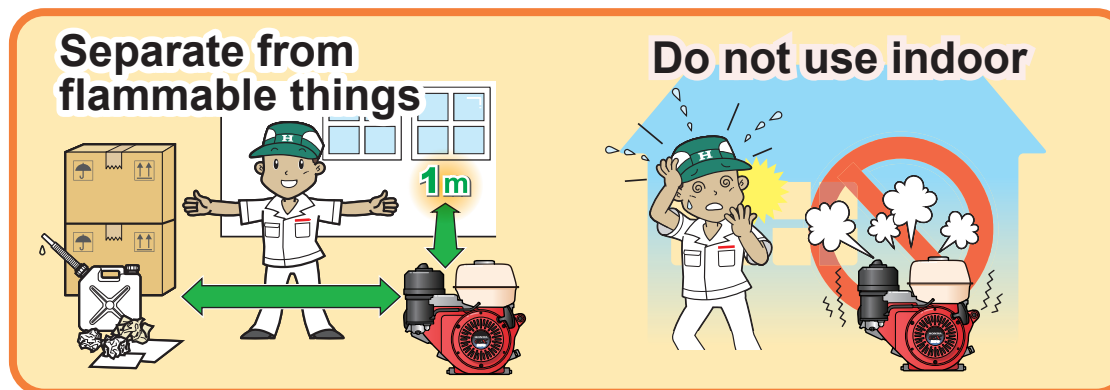

Safety Precaution

* Read and understand the Owner's Manual before operating the Engine

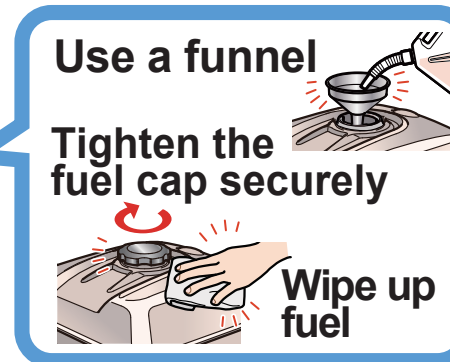
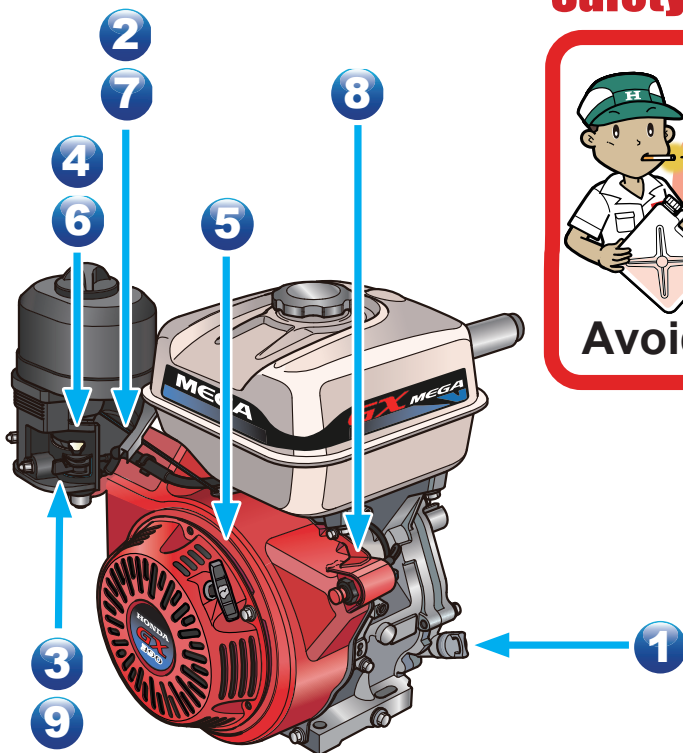

How to stop

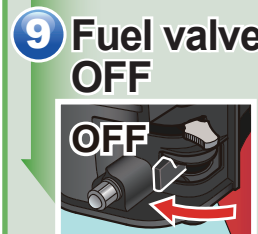

How to start

- 1 Engine oil Check
- 2 Throttle lever
- 3 Fuel valve ON
- 4 Choke
- 5 Start
- 6 (Choke Open)
- 7 Throttle lever

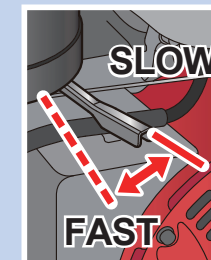
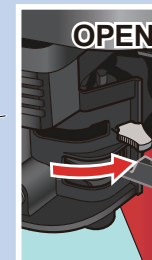
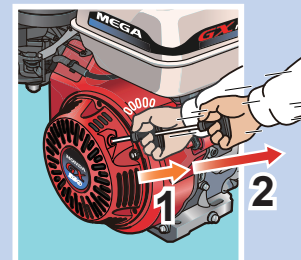
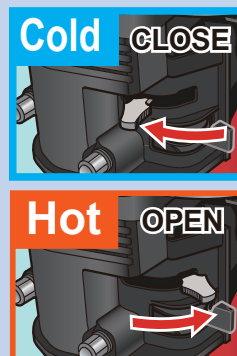
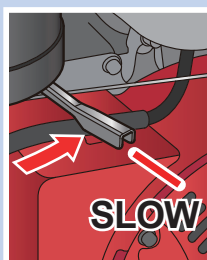
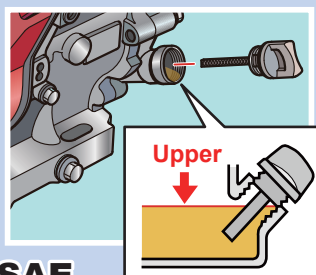

SAE
10W-30 MAX 1.1 l



Maintenance Schedule : Check : Change : Clean : Check-adjust : Grease up

Regular Service Period	Each use	After use	First month or 20 hrs.	Every 3 months or 50 hrs.	Every 6 months or 100 hrs.	Every year or 300 hrs.
Engine oil						
Engine stop switch						
Starter rope						
Spark plug						
Sediment cup						
Lubrication						
Engine outside						

Idle speed						
Valve clearance						
Fuel tank and filter						
Combustion chamber						
Fuel tube						

Take the Engine to your Honda servicing dealer.

After every 1000 hrs.

Every 2 years
Replace if necessary

* Service more frequently when used in salt water.

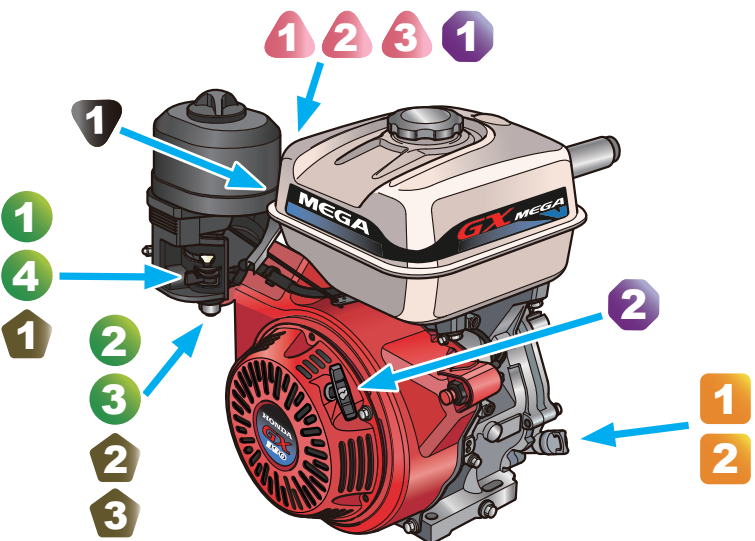

Engine Oil

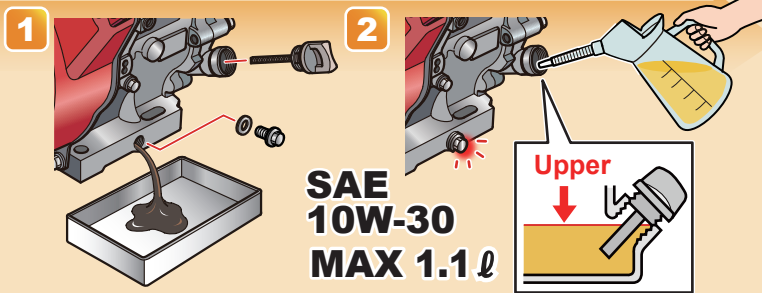

Spark Plug

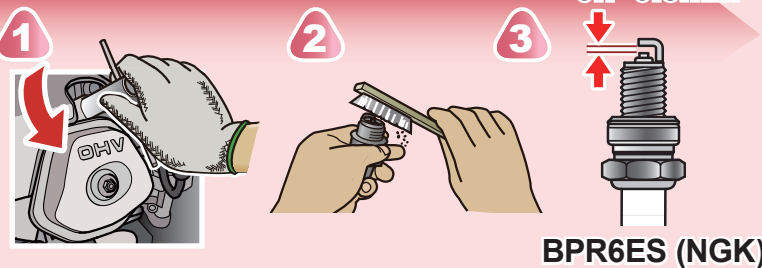

Storage

Carburetor Drain

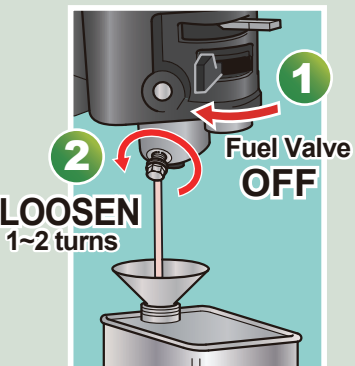

Fuel tank Drain

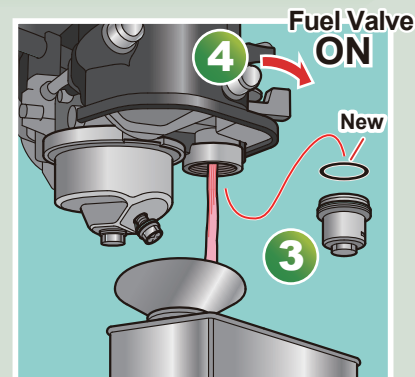

Starter Rope

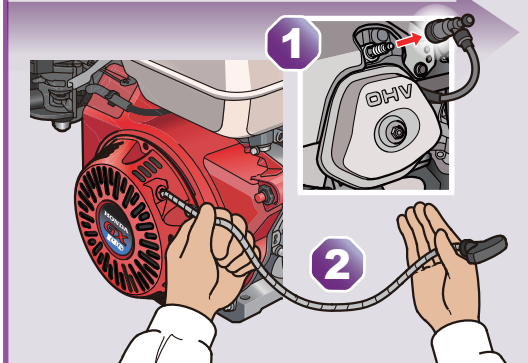

Lubrication

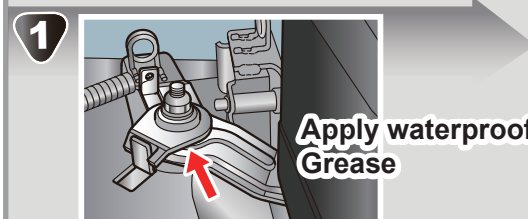

Sediment Cup

